



PIPE LAYING FLOATS- PARAL SERIES

These series of floats are used to break down the immersion velocity during pipe laying operations, as well as avoiding excessive bending of the pipes at time of deployment at sea.

The floats are manufactured from an outer shell made in UV-stabilized linear virgin polyethylene. The Polyethylene used in the manufacturing process is completely recyclable (Eco-Friendly), it's fully compatible with the marine environment, and has a high resistance to UV rays.

Being linear has the advantage that it can be melted and hence repaired by hot fusion welding. The colour pigment is moulded-in and consequently not added as a coating ensuring greater life of the colour and a big help to the environment as it never requires additional paintings, avoiding toxic dispersions in the water. Floatex polyethylene requires a minimal maintenance.

R&D laboratory daily performs tests on production samples such as tensile test, hardness test, abrasion test, UV test and Cold temperature test, colour test and other ordinary tests in the aim to ensure the quality and the reliability of Floatex polyethylene.

The floats are filled with closed-cell polyurethane foam with different density in base of the hydrostatic pressure the floats need to withstand. The polyurethane foam ensures great resistance to the leakage of air or water, ensuring unsinkability to the buoy also in case of accidental breaks of the outer shell. The polyurethane foam is 100% made and tested before production by our R&D laboratory.

Floats are fastened to the pipe by two straps (steel or nylon). Once the floats finish their works, can be eventually released by divers or by automatic self-releasing systems allowing the recovery of the floats at surface level.

Particular attention has been given during the design process, to develop elements with adequate dimensions that can fit in standard shipping containers in the aim to contain transport costs all over the world.

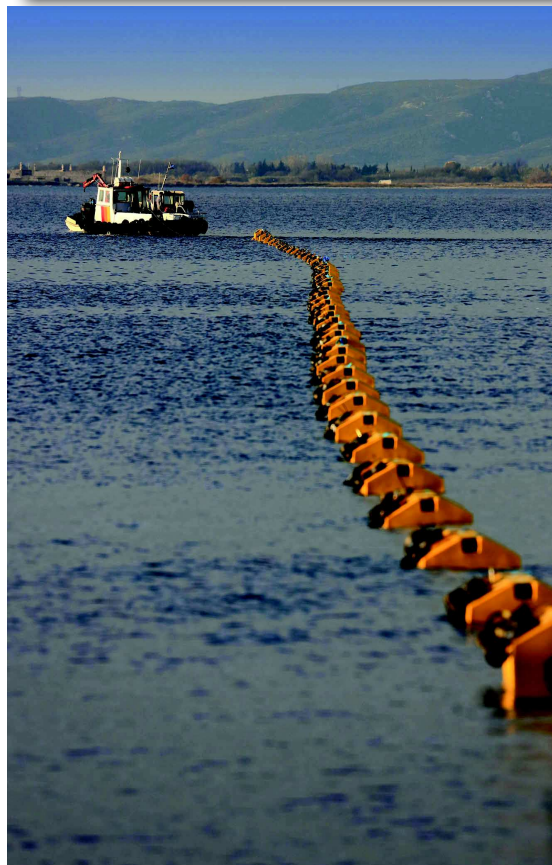

PIPE LAYING FLOAT- PARAL SERIES

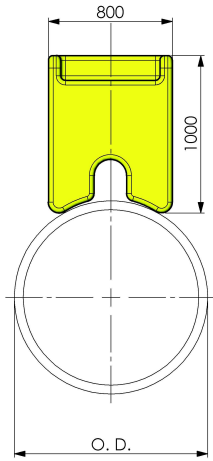

Min. O.D. : Ø 400 mm

Max O.D. : Ø 1500 mm

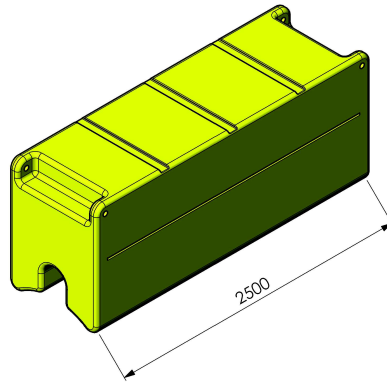

PARAL15/25		
WATER DEPTH	WEIGHT (kg)	N. B. (kg)
0 ÷ 20m	218	1546
20m ÷ 50m	276	1488
50m ÷ 100m	376	1388

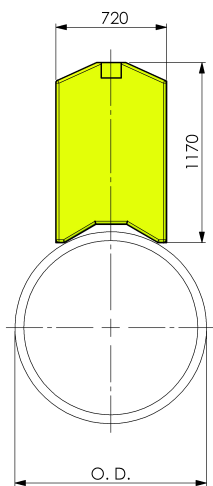

Min. O.D. : Ø 400 mm

Max O.D. : Ø 1500 mm

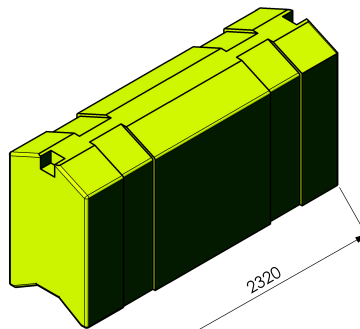

PARAL18/23		
WATER DEPTH	WEIGHT (kg)	N. B. (kg)
0 ÷ 20m	189	1609
20m ÷ 50m	243	1534
50m ÷ 100m	333	1444

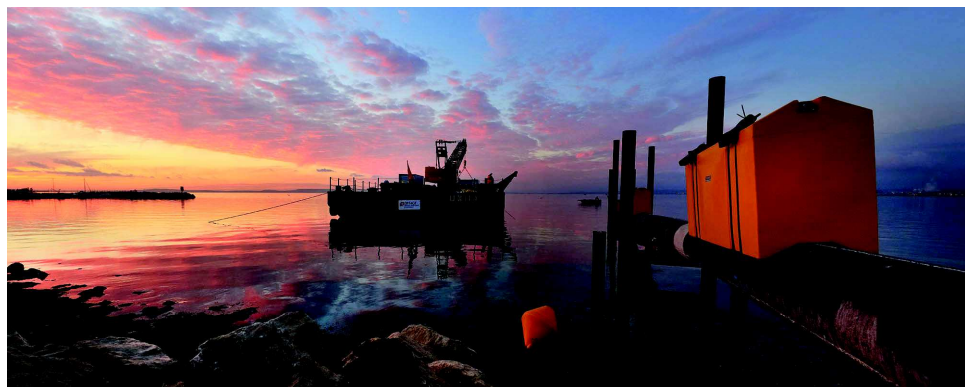

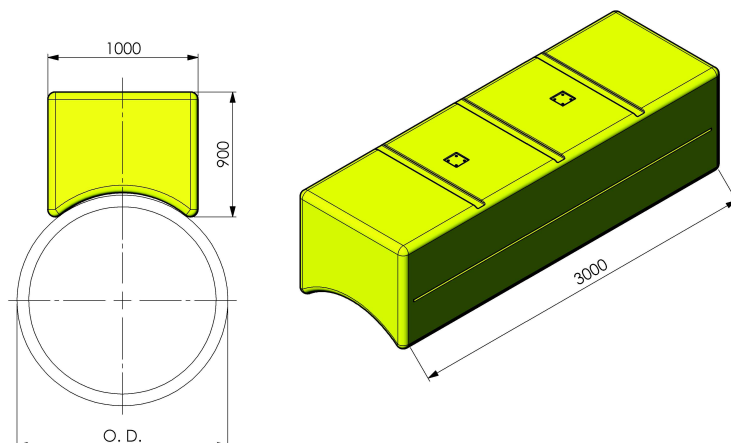
Min. O.D. : \varnothing 400 mmMax O.D. : \varnothing 1500 mm

PARAL19/30		
WATER DEPTH	WEIGHT (kg)	N. B. (kg)
0 ÷ 20m	261	1933
20m ÷ 50m	334	1860
50m ÷ 100m	454	1740



PIPE LAYING FLOAT- PARAL SERIES

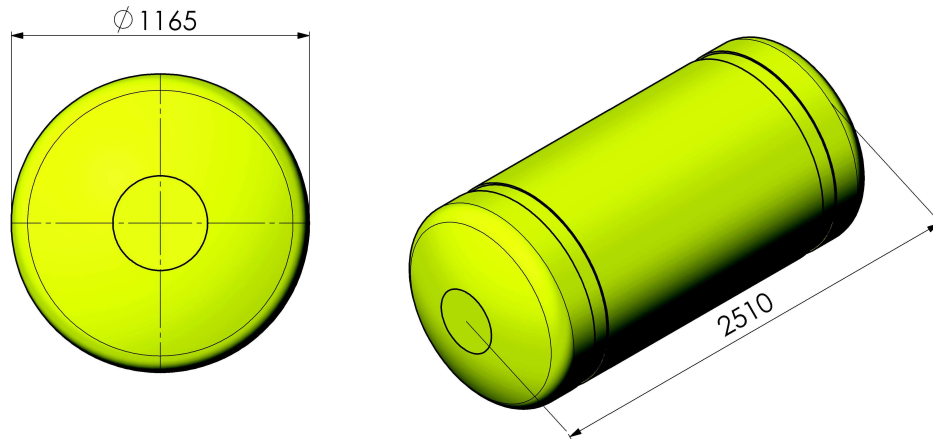

TIE-IN 12/25		
Water Depth	Weight (kg)	N. B. (kg)
0 - 20m	260	2270
20m - 50m	343	2187
50m - 100m	482	2048

