



## SUPPORTING FLOATS - PONT SERIES

These series of supporting floats and "PONT" floats are all manufactured following the latest technologies and using high quality raw materials which characterize Floatex products.

The floats are manufactured from an outer shell made in UV-stabilized linear virgin polyethylene. The Polyethylene used in the manufacturing process is completely recyclable (Eco-Friendly), it's fully compatible with the marine environment, and has a high resistance to UV rays.

Being linear has the advantage that it can be melted and hence repaired by hot fusion welding. The colour pigment is moulded-in and consequently not added as a coating ensuring greater life of the colour and a big help to the environment as it never requires additional paintings, avoiding toxic dispersions in the water. Floatex polyethylene require a minimal maintenance. R&D laboratory daily perform test on production samples such as tensile test, hardness test, abrasion test, UV test and Cold temperature test, colour test and other ordinary tests in the aim to ensure the quality and the reliability of Floatex polyethylene.

The floats are filled with closed-cell polyurethane foam with different density in base of the hydrostatic pressure the floats need to withstand. The polyurethane foam ensure great resistance to the leakage of air or water, ensuring unsinkability to the buoy also in case of accidental breaks of the outer shell. The polyurethane foam is 100% made and tested before production by our R&D laboratory.

These series can be used for different applications such as:

- Floating of the platforms(PONT 33 and PONT 18).
- Floating of the "Finger" on the modular piers.
- Floating of the pontoons (PONT 4).

The float PONT 500 and PARAL1100 are utilized for several uses from the construction of rafts to the supporting for the pipe laying.



## SUPPORTING FLOATS - PONT SERIES

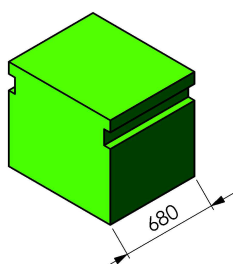
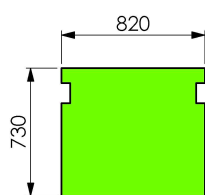

PONT4		
WATER DEPTH	WEIGHT (kg)	N. B. (kg)
0 ÷ 10m	42	327

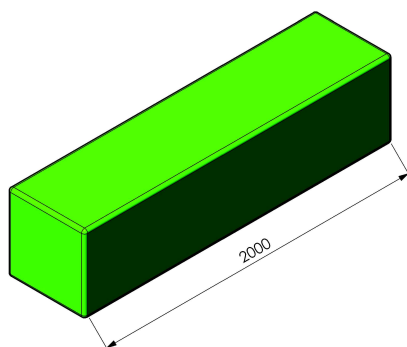
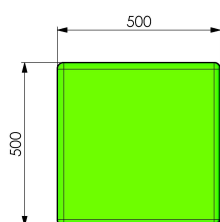

PONT500		
WATER DEPTH	WEIGHT (kg)	N. B. (kg)
0 ÷ 10m	51	448

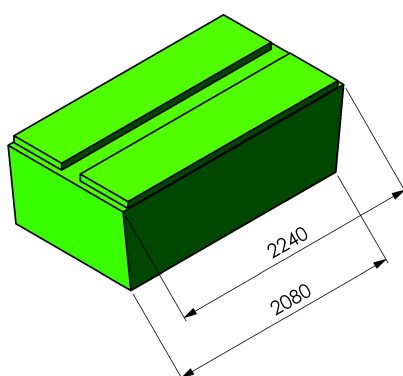
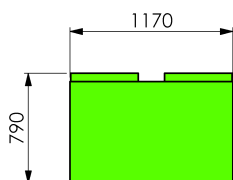

PONT18		
WATER DEPTH	WEIGHT (kg)	N. B. (kg)
0 ÷ 10m	163	1805

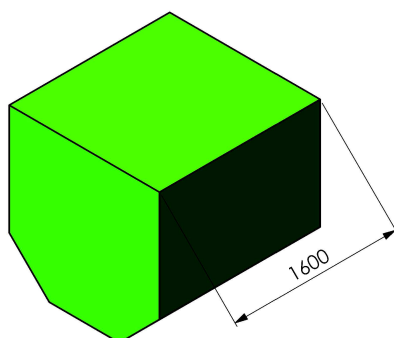
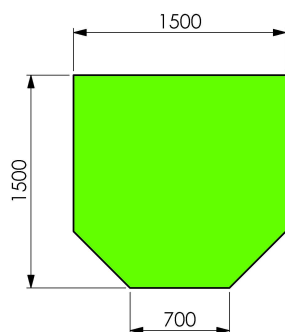

PONT33		
WATER DEPTH	WEIGHT (kg)	N. B. (kg)
0 ÷ 10m	250	3090

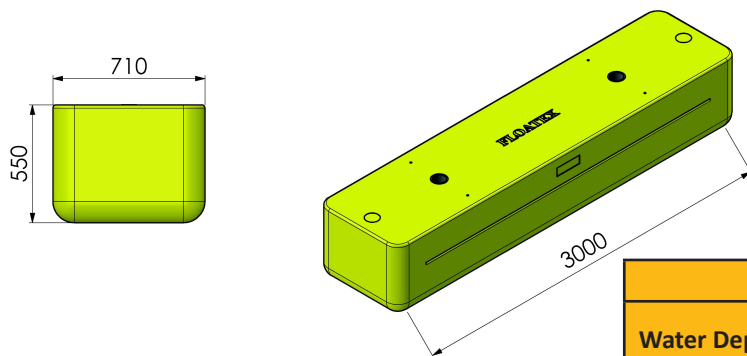

PAR 1100		
Water Depth	Weight (kg)	N. B. (kg)
0 - 10m	116	1020

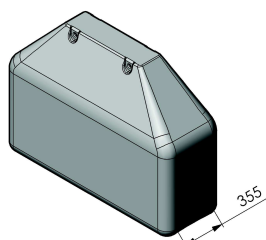
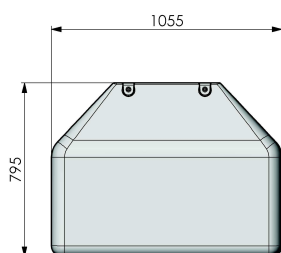

FINGER		
Water Depth	Weight (kg)	N. B. (kg)
0 - 10m	27	214

